



Flare Connectors

Catheter Connectors

Balloon Connectors



**97300**

0.051 inch Thru Hole (1.3 mm)  
PA



**97301**

0.061 inch Thru Hole (1.55 mm)  
PA



**97302**

0.061 inch Thru Hole (1.55 mm)  
PA

Flare Connectors



**97307**

0.049 inch  
Thru Hole  
(1.25 mm)  
PA



**97308**

0.069 inch  
Thru Hole  
(1.75 mm)  
PA



**97305**

0.077 inch  
Thru Hole  
(1.95 mm)  
PA



**97306**

0.081 inch  
Thru Hole  
(2.05 mm)  
PA



**97303**

0.094 inch  
Thru Hole  
(2.4 mm)  
PA



**97304**

0.094 inch  
Thru Hole  
(2.4 mm)  
PA



**97326**  
0.055 inch  
Thru Hole  
(1.4 mm)  
POM



**97324**  
0.055 inch  
Thru Hole  
(1.4 mm)  
POM



**97322**  
0.055 inch  
Thru Hole  
(1.4 mm)  
POM



**97323**  
0.133 inch  
Thru Hole  
(3.1 mm)  
POM



**97321**  
0.133 inch  
Thru Hole  
(3.1 mm)  
POM



**97325**  
0.154 inch  
Thru Hole  
(3.9 mm)  
POM



**97317**  
0.055 inch  
Thru Hole  
(1.4 mm)  
POM



**97315**  
0.067 inch  
Thru Hole  
(1.7 mm)  
POM



**97311**  
0.081 inch  
Thru Hole  
(2.05 mm)  
POM



**97319**  
0.085 inch  
Thru Hole  
(2.15 mm)  
POM



**97318**  
0.094 inch  
Thru Hole  
(2.4 mm)  
POM



**97312**  
0.108 inch  
Thru Hole  
(2.75 mm)  
POM



**97320**  
0.112 inch  
Thru Hole  
(2.85 mm)  
POM



**97316**  
0.133 inch  
Thru Hole  
(3.1 mm)  
POM



**97314**  
0.136 inch  
Thru Hole  
(3.45 mm)  
POM



**97310**  
0.150 inch  
Thru Hole  
(3.8 mm)  
POM



**97313**  
0.161 inch  
Thru Hole  
(4.1 mm)  
POM



Barbed Female Luer Locks



**65274**

0.107 inch ID x  
0.19 inch OD  
(2.7 mm x 4.8 mm)  
PVC

**80159**

0.107 inch ID x  
0.19 inch OD  
(2.7 mm x 4.8 mm)  
PVC

**80158**

0.107 inch ID x  
0.19 inch OD  
(2.7 mm x 4.8 mm)  
PVC

**11096** NEW!

0.19 inch OD  
Barb Connector  
(4.8 mm)  
PVC

**11097** NEW!

0.19 inch OD  
Barb Connector  
(4.8 mm)  
PVC

**11098** NEW!

0.19 inch OD  
Barb Connector  
(4.8 mm)  
PVC

Female Luer Locks to Bond Inside Catheter



**11093** NEW!

0.14 inch OD  
(3.5 mm)  
PVC

**11094** NEW!

0.14 inch OD  
(3.5 mm)  
PVC

**11095** NEW!

0.14 inch OD  
(3.5 mm)  
PVC

**65275**

0.15 inch OD  
(3.8 mm)  
PVC

**11109**

0.15 inch OD  
(3.8 mm)  
PVC

**11108**

0.15 inch OD  
(3.8 mm)  
PVC

Stepped Female Luer



**97330**

0.110 inch -  
0.281 inch OD  
(2.8 mm - 7.1 mm)  
HDPE

**97329**

0.110 inch -  
0.281 inch OD  
(2.8 mm - 7.1 mm)  
HDPE

**97328**

0.203 inch -  
0.484 inch OD  
(5.2 mm - 12.3 mm)  
HDPE

**51501**

0.236 inch -  
0.394 inch OD  
(6 mm - 10 mm)  
ABS

**51500**

0.236 inch -  
0.512 inch OD  
(6 mm - 13 mm)  
ABS

**11519**

0.276 inch -  
0.421 inch OD  
(7 mm - 10.7 mm)  
Acrylic



## Catheter Hub



**41523**  
2.7 FR  
(0.035 inch;  
0.9 mm)  
PC



**51502**  
2.7 FR  
(0.035 inch;  
0.9 mm)  
PC



**41425**  
4 FR  
(0.058 inch -  
0.056 inch;  
1.5 mm)  
PC



**41518**  
4 FR  
(0.058 inch -  
0.056 inch;  
1.5 mm)  
PC



**41426**  
5 FR  
(0.071 inch -  
0.069 inch;  
1.8 mm)  
PC



**41519**  
5 FR  
(0.071 inch -  
0.069 inch;  
1.8 mm)  
PC



**41427**  
6 FR  
(0.083 inch - 0.081 inch;  
2.1 mm)  
PC



**41520**  
6 FR  
(0.083 inch - 0.081 inch;  
2.1 mm)  
PC



**41521**  
8 FR ID  
(0.109 inch - 0.107 inch;  
2.8 mm)  
PC



**41428**  
8 FR ID  
(0.109 inch - 0.107 inch;  
2.8 mm)  
PC

## Fixing Wings



**41421**  
4.5 FR Thru Hole  
(0.058 inch; 1.47 mm)  
Pebax

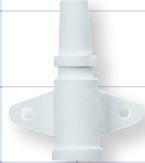

**65821**  
4.5 FR Thru Hole  
(0.058 inch; 1.47 mm)  
Kraton

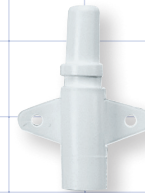

**65822**  
7 FR Thru Hole  
(0.091 inch; 2.3 mm)  
PVC

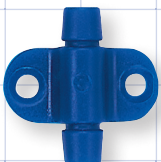

**41423**  
7 FR Thru Hole  
(0.091 inch; 2.3 mm)  
Pebax

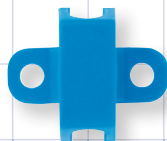

**21500**  
12 FR Thru Hole  
(0.156 inch; 4 mm)  
HDPE



**65199**  
14 FR Thru Hole  
(0.180 inch; 4.5 mm)  
PVC/PU Blend

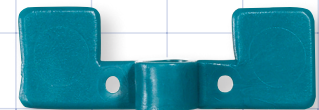

**65198**  
15 FR Thru Hole  
(0.195 inch; 5 mm)  
PVC/PU Blend